

Creating Reports

You can create a report based on the current inspection and analysis results. This report can be saved in PDF.

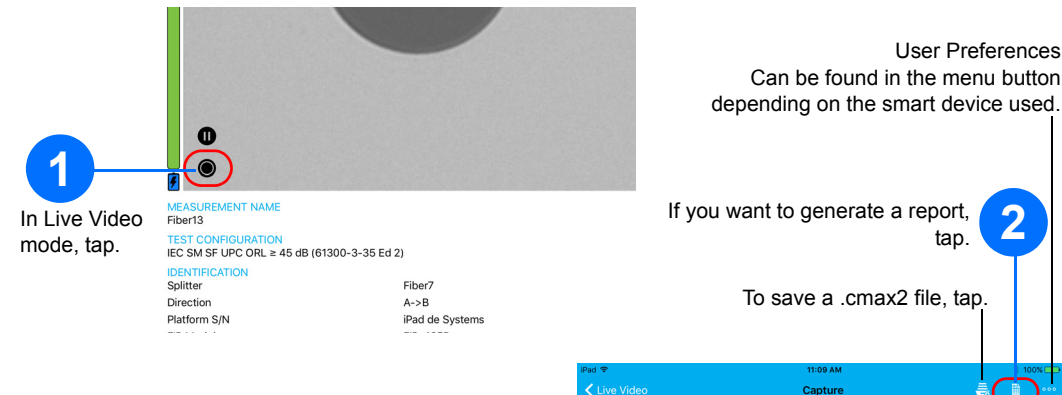

Viewing Reports

If you want to open a report that was previously saved, in Live Video mode, tap.

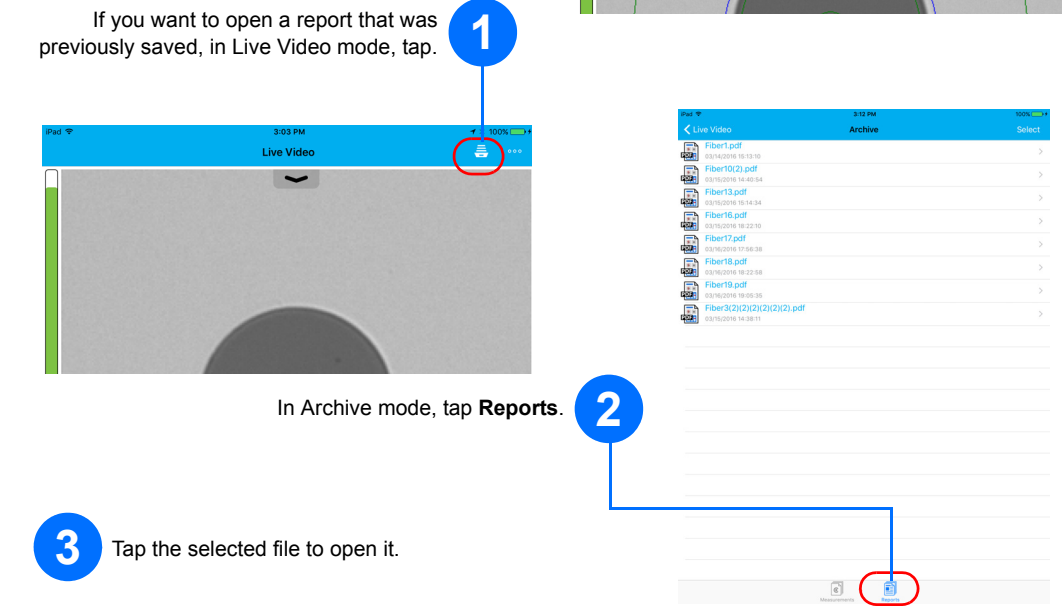

Transferring Results With Third-Party Applications From the Archive Mode

The data that can be shared are measurement files (.cmax2) and images (.png).

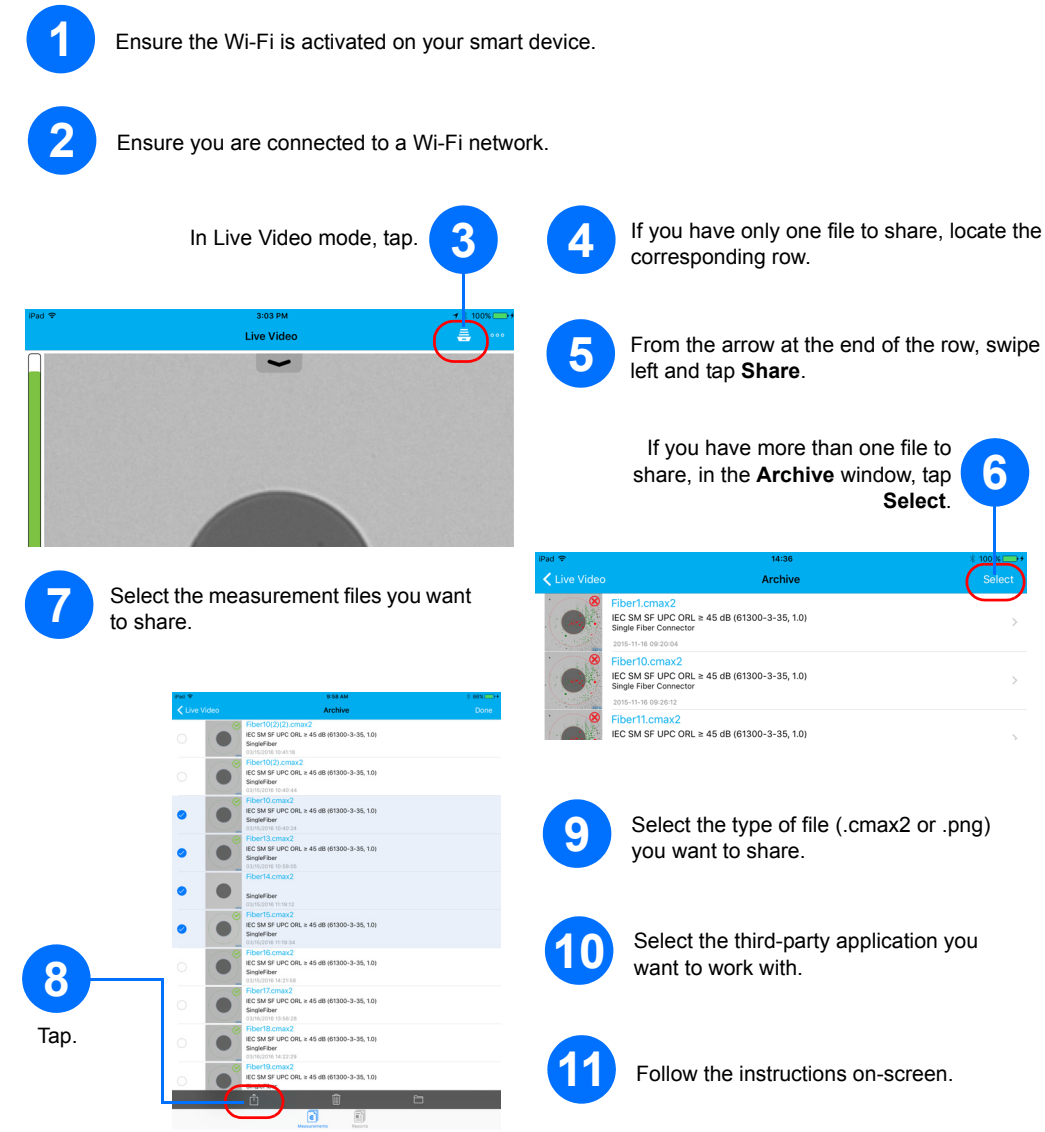

© 2016 EXFO Inc. All rights reserved.
Printed in Canada (2016-07)
P/N: 1069854 Version: 1.0.0.1



FIP-400B and ConnectorMax2 Mobile (iOS)

Fiber Inspection Probe and ConnectorMax2 Mobile

The FIP-400B Fiber Inspection Probe is a portable video microscope used to inspect fiber-optic terminations. Using ConnectorMax2 Mobile, its dedicated software, you can view the fiber directly, or capture and analyze the results.

Note: The appearance and the orientation (portrait or landscape) of the application may vary depending on the smart device used.

Installing ConnectorMax2 Mobile on the iOS Smart Device

Before you start working with your wireless probe, you need to install the ConnectorMax2 Mobile free application on your smart device.

Note: You need to have an Apple ID to download the application. For more information, visit www.apple.com.

- 1 Ensure you have access to an Internet connection.
- 2 Tap the App Store icon.
- 3 In the App Store application, search for EXFO or ConnectorMax2 Mobile.
- 4 Follow the instructions on-screen.

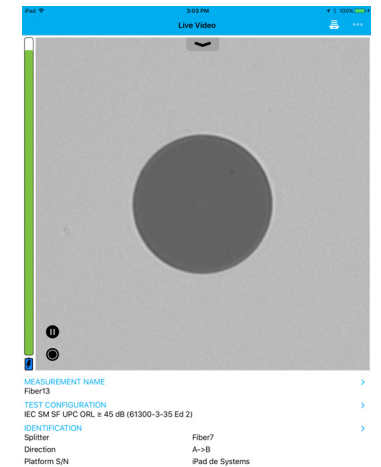

For more information, refer to the user guide.

Changing Probe Tips

You can use different probe tips depending on the type of connector you are inspecting.

1 Untighten tip retaining nut.

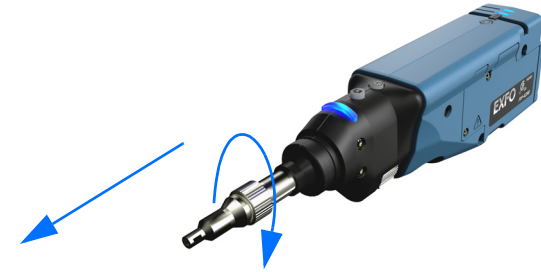

2 Remove tip.



3 Insert new tip in, aligning the notch on the tip properly on the probe.



4 Retighten tip retaining nut.

Inspecting Fiber Connectors

When you connect the FIP-400B Fiber Inspection Probe to your smart device, you can view and inspect fiber ends right away.

- 1 Turn on the probe.
- 2 Ensure the Wi-Fi is activated on your smart device.
- 3 Go to the device Settings and select Wi-Fi.
- 4 Select the wireless probe you want to work with.

5 Start the ConnectorMax2 Mobile application.

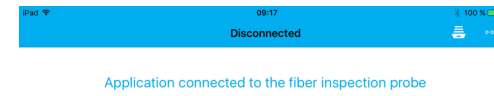

7 Install a probe tip.

8 Insert the fiber into the probe tip.

Note: When working with a FIP-435B, the auto capture is enabled by default. A capture is made automatically when all conditions are met. You can disable the auto capture in the probe controls after the first capture is made.

Tap **Start Live Video**.



Tap the **Measurement Name** row to configure the automatic file naming.

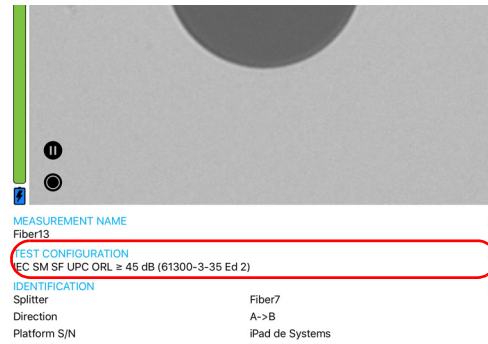

10 In Live Video mode, tap the **Test Configuration** row.

Select a test configuration under **Single Fiber Connector** or **Transceiver**.

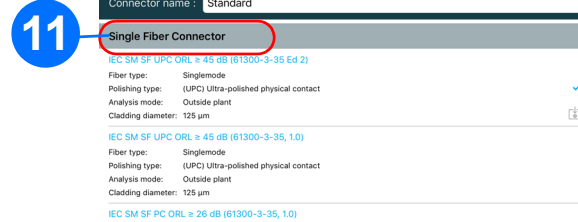

12 In Live Video mode, tap the **Test Configuration** row.

Tap in the box next to **Connector Name** to choose the type of connector you want to use.

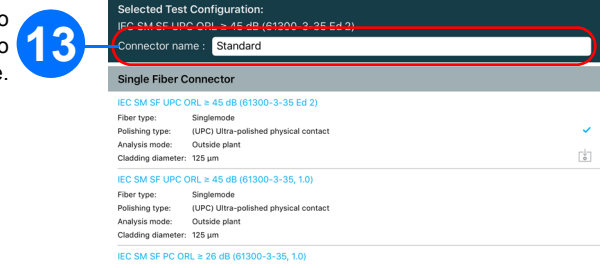

14 Scroll through the connector types.

15 Tap **Done** to confirm your choice.

16 In Live Video mode, touch the arrow.

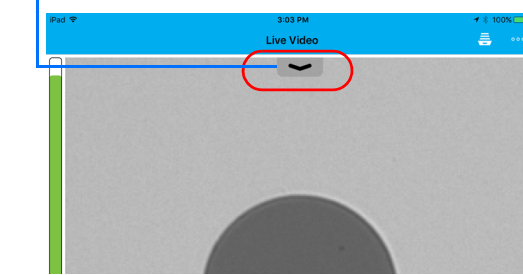

17 Select the analysis features by activating the corresponding button.

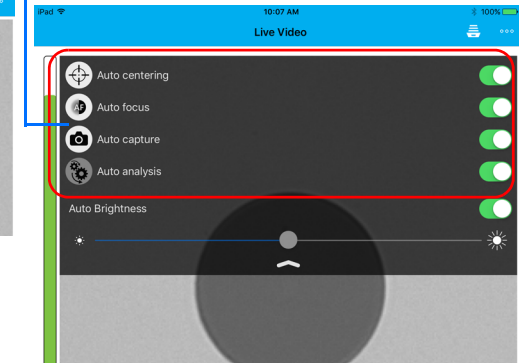

18 If the fiber end is dirty, remove it from the probe, clean it and reinspect it.

When in high magnification level, to make a capture, tap.

OR
Press the Fiber Inspection Probe handset button.

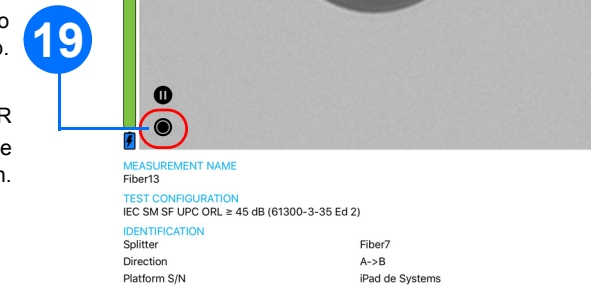

20 Repeat steps 9 to 19 for the next connector or close the application.